

Tapping clamps

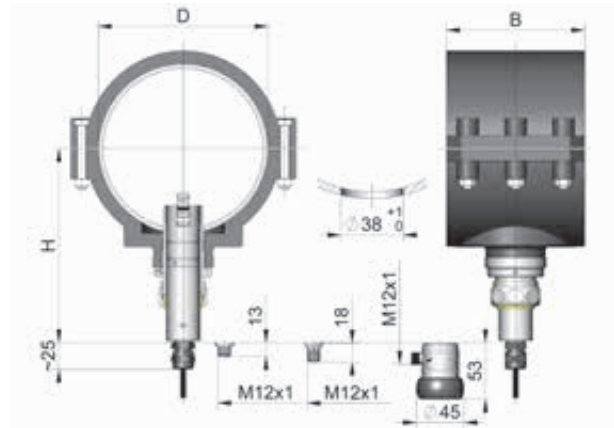

Dimensions



Features

The tapping clamps described below can be used for installation of impeller probes of the series RR.-032 in industrial PVC-U pipeline systems. Of course, they are also suitable for installation in pipeline systems made of other materials having the same outer diameters. They offer the advantage that they can be retrofitted without having to cut the pipeline or carry out welding work.

A bore hole diameter of only 38 mm is required. The nozzle of the tapping clamp immerses into this bore hole. The (curved) surface must be secured around the bore hole so that the seal is guaranteed by the O-ring affixed in the clamp.

Installation of the impeller probe in the clamp takes place with the clamping ring with union nut supplied with the probe.

The installation point should be chosen such that an uninterrupted (no valves, bends, edges, etc.) inlet and outlet section having a length of at least 10 times the inner diameter of the pipe is provided upstream and downstream from the probe.

Technical data

| | | |
|-----------------------------|-------------|------------------|
| Wetted materials | Probe mount | PVC-U |
| | Clamp | Polypropylene |
| | Seal | Fluororubber FKM |
| Compressive strength | PN10 | |

| Type | D | B | H |
|--------------|-----|-----|-----|
| BBI-032H-063 | 63 | 71 | 145 |
| BBI-032H-075 | 75 | 91 | 154 |
| BBI-032H-090 | 90 | 91 | 156 |
| BBI-032H-110 | 110 | 98 | 166 |
| BBI-032H-125 | 125 | 101 | 167 |
| BBI-032H-140 | 140 | 134 | 172 |
| BBI-032H-160 | 160 | 137 | 180 |

Ordering code

BBI-032H- 1.

| 1. | For outer pipe diameter |
|-----|-------------------------|
| 063 | 63 mm |
| 075 | 75 mm |
| 090 | 90 mm |
| 110 | 110 mm |
| 125 | 125 mm |
| 140 | 140 mm |
| 160 | 160 mm |